

TWO BEDROOM, FIRST FLOOR APARTMENT

**10 Owen Court, Plot 81. Audley Sunningdale Park,
Silwood Road, Ascot, Berkshire SL5 0QB
01344 859 239**

Property specifications:

- Dual-aspect apartment
- Large double bedroom with en suite shower room and built-in double wardrobes
- Second double bedroom
- Hallway storage
- South-facing kitchen
- Bathroom and en suite fitted with elegant white Geberit sanitaryware
- Open plan kitchen and living space
- South-west facing balcony accessible from living room
- Dual-aspect living/dining room

Please see the village brochure and key facts for further information.



THE LAYOUT

**10 Owen Court, Plot 81. Audley Sunningdale Park,
Silwood Road, Ascot, Berkshire SL5 0QB**

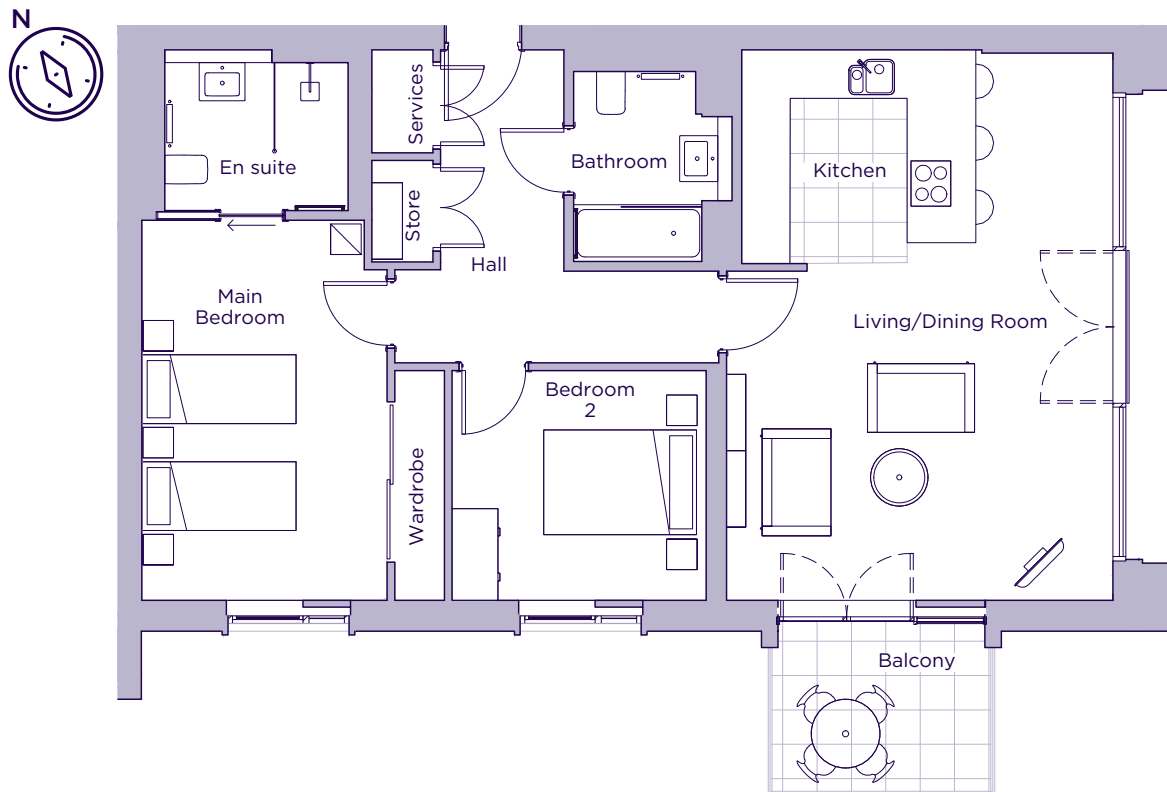

| Internal Measurements | Metric (m) | Imperial (ft) |
|-----------------------|-------------|----------------|
| Living/Dining Room | 5.05 x 4.30 | 15'3" x 14'2" |
| Kitchen | 3.50 x 2.80 | 10'4" x 9'2" |
| Main Bedroom | 4.97 x 3.20 | 16'4" x 10'6" |
| Bedroom 2 | 3.33 x 3.00 | 10'11" x 9'10" |
| Balcony (approx.) | 2.86 x 1.88 | 20'4" x 5'9" |

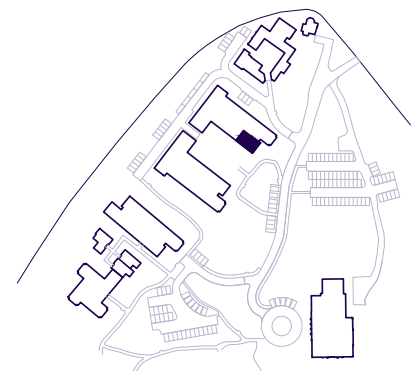

These floor plans are illustrative and for marketing purposes only. Maximum measurements are shown with longer dimension quoted first. Dimensions are quoted for the main area of the room only. Built-in wardrobes not included in the overall room dimensions. Furniture shown to illustrate possible room layouts and not included in sale. Designs vary according to plot. All details should be checked at the Sales Office. June 2021.