



TWO BEDROOM, THIRD FLOOR APARTMENT

**16 Owen Court, Plot 96. Audley Sunningdale Park,
Silwood Road, Ascot, Berkshire SL5 0QB
01344 859 239**

Property specifications:

- Main bedroom with built-in wardrobes and en suite shower room
- Modern SieMatic kitchen with integrated appliances
- Luxury Villeroy & Boch sanitaryware and Hansgrohe fittings
- Juliet balcony in living room and additional Juliet balcony in main bedroom
- Open plan kitchen and living space with room for a dining table
- Private roof terrace accessible from second bedroom and study

Please see the village brochure and key facts for further information.



Images for illustration purposes only.

THE LAYOUT

**16 Owen Court, Plot 96. Audley Sunningdale Park,
Silwood Road, Ascot, Berkshire SL5 0QB**

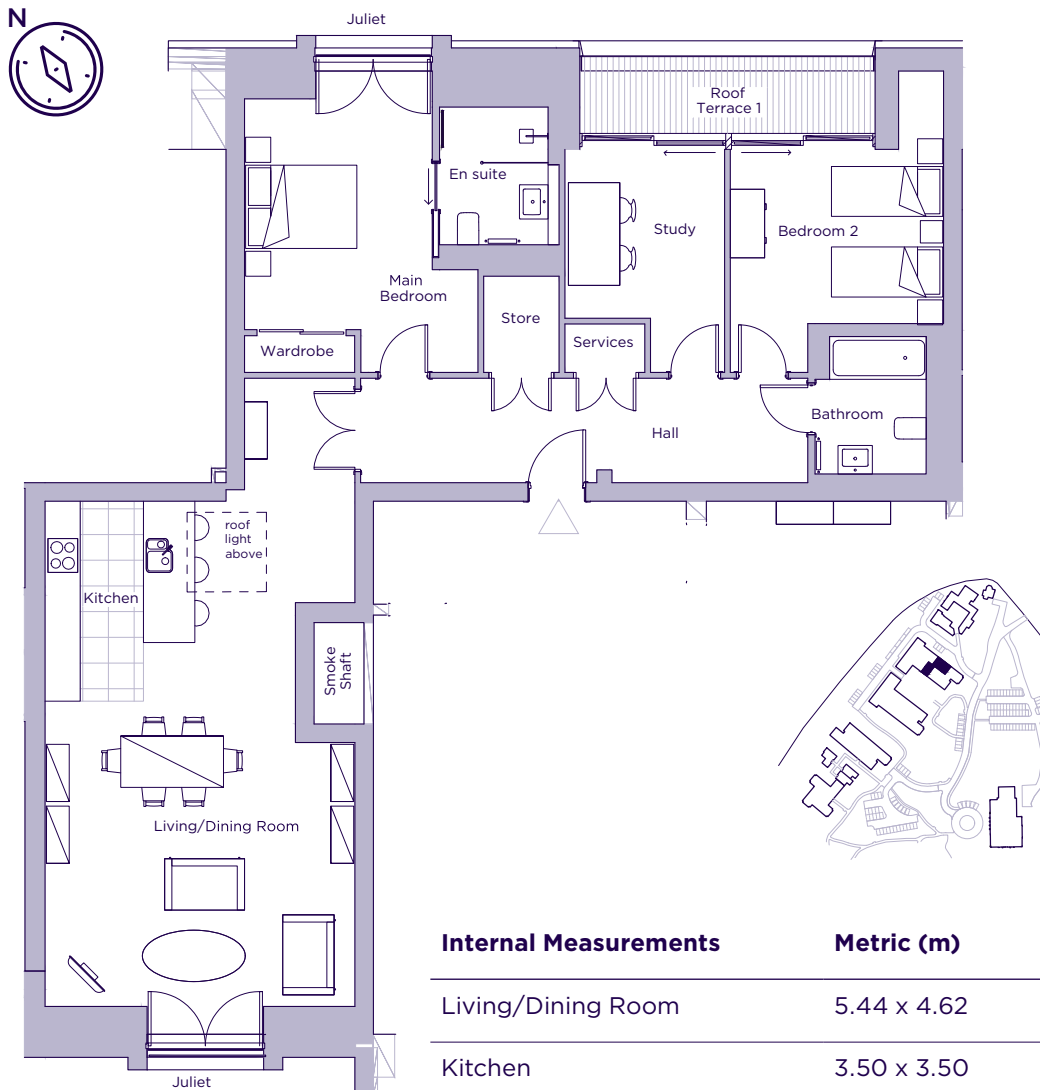

Internal Measurements	Metric (m)	Imperial (ft)
Living/Dining Room	5.44 x 4.62	17'10" x 15'2"
Kitchen	3.50 x 3.50	11'6" x 11'6"
Main Bedroom	4.04 x 3.29	13'3" x 10'10"
Bedroom 2	3.74 x 3.05	12'3" x 10'0"
Study	3.00 x 2.85	9'10" x 9'4"
Terrace (approx.)	5.11 x 1.35	16'9" x 4'5"

These floor plans are illustrative and for marketing purposes only. Maximum measurements are shown with longer dimension quoted first. Dimensions are quoted for the main area of the room only. Built-in wardrobes not included in the overall room dimensions. Furniture shown to illustrate possible room layouts and not included in sale. Designs vary according to plot. All details should be checked at the Sales Office. June 2021.