

TWO BEDROOM, DUPLEX APARTMENT

**10 Newman Drive, Scarcroft Lodge, Plot D02. Audley Scarcroft Park,
Scarcroft Estate, Leeds, West Yorkshire LS14 3HS
0800 093 8181**

Property specifications:

- Dual-aspect duplex property with unique layout
- Double bedroom with en suite shower room and built-in wardrobes
- Second double bedroom
- Terrace accessible from main bedroom
- Modern Nobilia kitchen and integrated appliances
- Bathroom and en suite fitted with elegant white Geberit sanitaryware
- Additional guest bathroom
- Separate shower room

Please see the village brochure and key facts for further information.



Images for illustration purposes only.

THE LAYOUT

**10 Newman Drive, Scarcroft Lodge, Plot D02 Audley Scarcroft Park,
Scarcroft Estate, Leeds, West Yorkshire LS14 3HS**

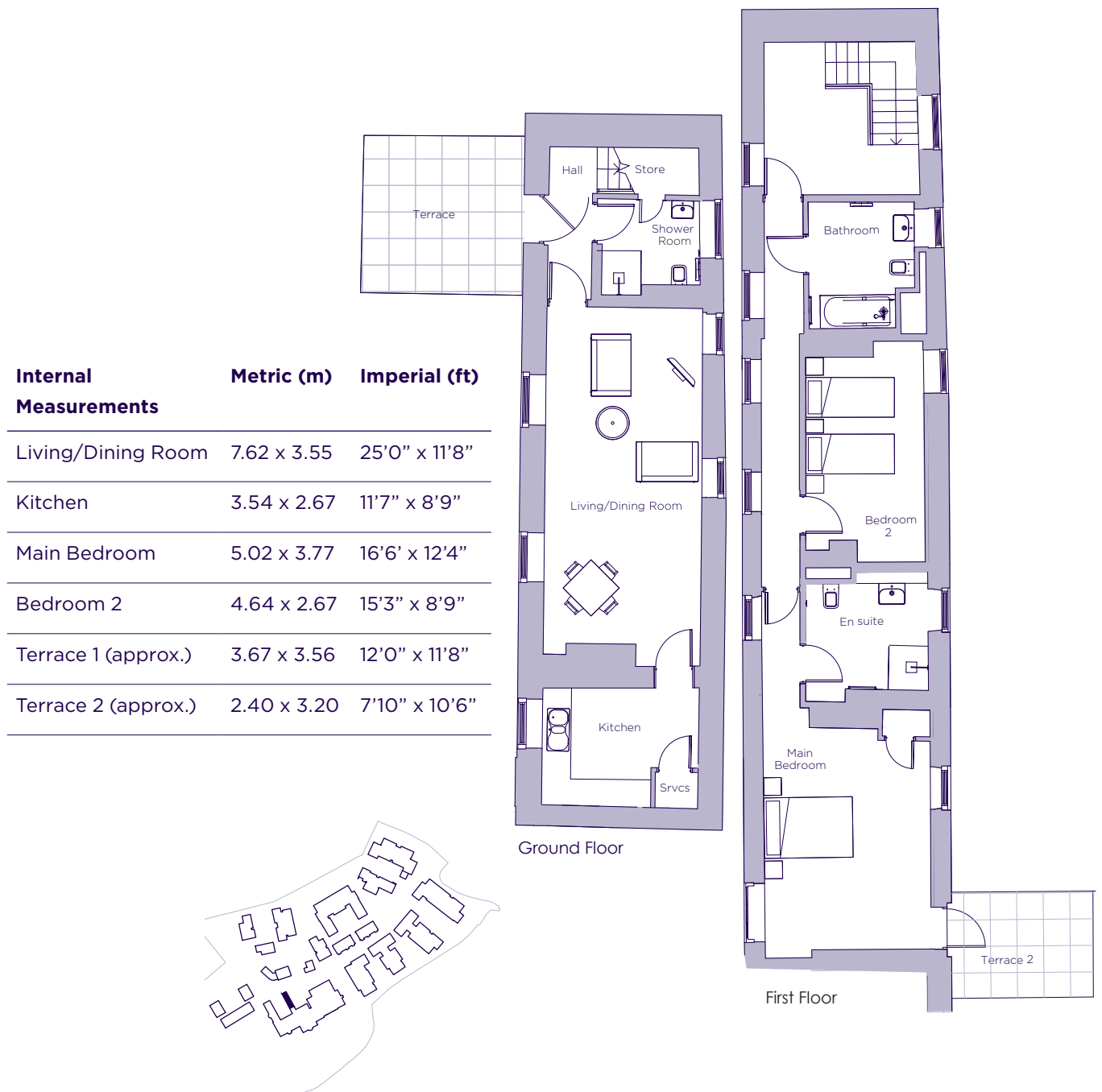

These floor plans are illustrative and for marketing purposes only. Maximum measurements are shown with longer dimension quoted first. Dimensions are quoted for the main area of the room only. Built-in wardrobes not included in the overall room dimensions. Furniture shown to illustrate possible room layouts and not included in sale. Designs vary according to plot. All details should be checked at the Sales Office. July 2022.